

PVC Coated Liquidtight Connectors - Straight

Calbond PVC coated liquidtight connectors are used with Liquidtight Conduit. The sleeve on the liquidtight connector is sized specifically to tighten around PVC conduit. Pulling compound is recommended for ease of installation. Fittings are provided with a flexible sleeve on the conduit side and a sealing form on both the box side and the mating part of the gland.

Features:

- Exterior PVC coating thickness is a minimum 0.040"
- Sizes available are 1/2" to 4"
- The length of the sleeve extension(s) shall be at least equivalent to the nominal conduit size for sizes 1/2" - 2". For sizes 2-1/2" - 6", the length of the sleeve extension(s) shall be at least 2".
- Available in straight, 45 degree or 90 degree body configurations

Standards:

- CSA Standard: C22.2 No. 18

UL listings include:

- Ferrous electrical conduit: File # DYIX.E226472
- Ferrous electrical conduit with PVC coating: File # DYJC.E226472

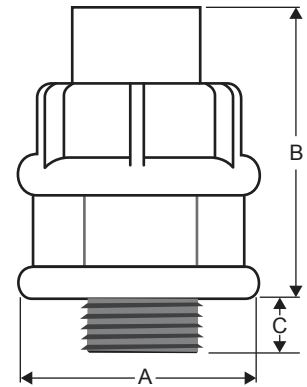

Straight						
Item Number	Trade Size	A	B	C	Weight Per 100 (lbs)	Aluminum Item Number
PV0300LT38	3/8"	1.24	1.88	0.56	20	
PV0500LT50	1/2"	1.46	2.06	0.56	20	PV0500LT50SA
PV0700LT75	3/4"	1.74	2.38	0.56	30	PV0700LT75SA
PV1000LT100	1"	1.96	3.06	0.75	40	PV1000LT100SA
PV1200LT125	1-1/4"	2.36	3.75	0.81	80	PV1200LT125SA
PV1500LT150	1-1/2"	2.80	4.19	0.81	90	PV1500LT150SA
PV2000LT200	2"	3.33	5.06	0.88	170	PV2000LT200SA
PV2500LT250	2-1/2"	3.83	6.13	1.00	300	PV2500LT250SA
PV3000LT300	3"	4.58	6.25	1.00	420	PV3000LT300SA
PV4000LT400	4"	5.58	6.50	1.13	620	PV4000LT400SA