

Core & Coil (71A) MH ~GT~ 450W

CORE & COIL HID MH BAL 750W M149 277/347/480V KIT

The basic ballast is the open core and coil which is most often used as a component within a lighting luminaire. The core and coil also forms the nucleus of Philips Advance's five other ballast configurations.

Product data

General Information		Operating and Electrical	
ANSI Code	M149	Input Voltage	277/34/480 V
Lamp Type	750W MH	Input Frequency	60 Hz
Number of Lamps	1 piece/unit	Power (Rated) (Nom)	750 W
Circuit Type	SUPER-CWA	Inp. Current (Open Circuit)	1.8/1.45/1 A
Ballast Type	Magnetic HID	Input Current (Starting)	2.2/1.65/1.25 A
Base Model	71A64F2	Input Current (Short Circuit)	1.7-2.6/1.35-2.05/1-1.5 V
Core Size	4 1/4 x 6 (2 Coil)	Secondary Short Circuit Current	5-6 A
Suitable For Outdoor Use	Yes	Constant Wattage Deviation	10%
Ignitor Catalog Number	LI573-H5	Ballast Factor (Nom)	1
Ignitor Temperature Rating	105°C	Power Factor (Nom)	0.90
Capacitor Value	28 MFD	Nominal Open Circuit Voltage	355 V
Capacitor Catalog Number	7C280S40	Input Current (Operating) (Nom)	3/2.45/1.75 A A
Capacitor Requirements	400V	Input Power (Nom)	818 W
Capacitor Temperature Rating	105°C	Rated Lamp Watts	750W W
Capacitor Diameter/Oval Dimensions	2 in		
Capacitor Height	4.80 in		
Automatic Restart	No		
		Wiring	
		Wire Striplength	0.5 mm
		Wire Length By Color	12"

Core & Coil (71A) MH ~GT~ 450W

Wire Type	Stranded
Remote Wiring Configuration Allowed	Yes
Max Ballast-Lamp Distance Remote Wiring	15'
Recommended Fuse Value	8/7/5 A

Approval and Application

Open Circuit Voltage Test (Volts)	320-390 V
Approbation Marks	ULR CSA certificate RoHS Compliant
Temperature Marking	E/E/E
UL Recognized	Yes
Hipot Test (1 Minute)	2000 V
Hipot Test (2 Seconds)	2500 V
UL Insulation Class	H(180°C)

UL Temperature Code	1029E
---------------------	-------

Product Data

Order product name	CORE & COIL HID 71A64F2001D
EAN/UPC - Product	781087052198
Order code	71A64F2001D
Numerator - Quantity Per Pack	1
Numerator - Packs per outer box	1
Material Nr. (12NC)	913710605001
Net Weight (Piece)	8.587 kg

Dimensional drawing

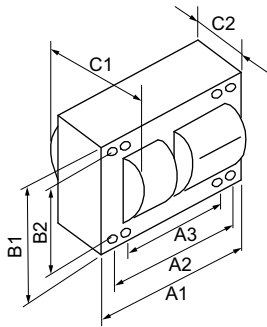

MH BAL 750W M149 277/347/480V KIT

Product	C1	C2	A1	A2	A3	B1	B2
CORE & COIL HID 71A64F2001D	4.25 in	2.28 in	6 in	5.4 in	4.4 in	4.3 in	3.9 in

