

Core & Coil (71A) MH 175W - 450W

CORE & COIL HID 71A5742500DTEE

The basic ballast is the open core and coil which is most often used as a component within a lighting luminaire. The core and coil also forms the nucleus of Philips Advance's five other ballast configurations.

Product data

General Information	
ANSI Code	M138-M153
Lamp Type	250W MH
Number Of Lamps	1 piece/unit
Circuit Type	SUPER-CWA
Ballast Type	Magnetic HID
Base Model	71A5742TEE
Core Size	4 1/4 x 4 3/4 (2 coil)
Suitable For Outdoor Use	Yes
Ignitor Catalog Number	LI533-H4
Ignitor Temperature Rating	105°C
Capacitor Value	17 MFD
Capacitor Catalog Number	7C170P40
Capacitor Requirements	340V
Capacitor Temperature Rating	105°C
Capacitor Diameter/Oval Dimensions	1.75 in
Capacitor Height	3.75 in
Automatic Restart	No

Operating and Electrical	
Input Voltage	480/120T V
Input Frequency	60 Hz
Input Current (Open Circuit)	0.47 A
Input Current (Starting)	0.41 A
Input Current (Short Circuit)	0.33-0.50 A
Secondary Short Circuit Current	2.44-2.99 A
Constant Wattage Deviation	10%
Ballast Factor (Nom)	1
Power Factor (Nom)	0.90
Open Circuit Voltage	290 V
Input Current (Nom)	0.64 A A
Input Power (Nom)	283 W
Rated Lamp Power	250 W

Wiring	
Wire Striplength	0.5 mm
Wire Length By Color	12"
Wire Type	Stranded
Remote Wiring Configuration Allowed	Yes

Core & Coil (71A) MH 175W - 450W

Max Ballast-Lamp Distance Remote Wiring	2'
Recommended Fuse Value	2 A

Approval and Application

Open Circuit Voltage Test (Volts)	261-319 V
Approval Marks	ULR CSA certificate EISA RoHS Compliant
Temperature Marking	A
UL Recognized	Yes
Hipot Test (1 Minute)	2000 V
Hipot Test (2 Seconds)	2500 V
UL Insulation Class	H(180°C)
UL Temperature Code	1029A

Product Data

Order product name	CORE & COIL HID 71A5742500DTEE
EAN/UPC - Product	781087070338
Order code	913710665402
Numerator - Quantity Per Pack	1
Numerator - Packs per outer box	4
Material Nr. (12NC)	913710665402
Net Weight (Piece)	6.101 kg

Dimensional drawing

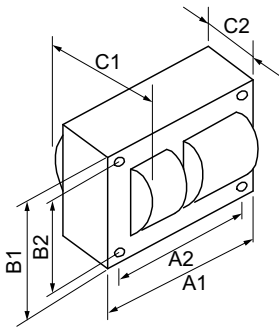

MH BAL 250W M138/M153 480V/120T C&C

Product	C1	C2	A1	A2	B1	B2
CORE & COIL HID 71A5742500DTEE	4.05 in	2.15 in	4.8 in	4.4 in	4.3 in	3.9 in

