

Core & Coil (71A) MH 175W - 450W

CORE & COIL HID 71A60A1001D

The basic ballast is the open core and coil which is most often used as a component within a lighting luminaire. The core and coil also forms the nucleus of Philips Advance's five other ballast configurations.

Product data

General Information	
ANSI Code	M59
Lamp Type	400W MH
Number Of Lamps	1 piece/unit
Circuit Type	CWA
Ballast Type	Magnetic HID
Base Model	71A60A1A
Core Size	4 1/4 x 4 3/4 (2 coil)
Suitable For Outdoor Use	Yes
Ignitor Catalog Number	NA
Ignitor Temperature Rating	NA
Capacitor Value	24 MFD
Capacitor Catalog Number	7C240P40R
Capacitor Requirements	400V
Capacitor Temperature Rating	105°C
Capacitor Diameter/Oval Dimensions	1.75 in
Capacitor Height	4.8 in
Automatic Restart	No

Operating and Electrical	
Input Voltage	120/277/347 V
Input Frequency	60 Hz
Power (Rated) (Nom)	400 W
Input Current (Open Circuit)	2.6/1.2/0.9 A
Input Current (Starting)	2.6/1.2/0.9 A
Input Current (Short Circuit)	2.75-4.2/1.2-1.8/0.95-1.45 A
Secondary Short Circuit Current	3.5-4.3 A
Constant Wattage Deviation	10%
Ballast Factor (Nom)	1
Power Factor (Nom)	0.90
Open Circuit Voltage	300 V
Input Current (Nom)	4/1.75/1.4 A A
Input Power (Nom)	460 W
Rated Lamp Power	400W W

Wiring	
Wire Striplength	0.5 mm
Wire Length By Color	12"
Wire Type	Stranded

Core & Coil (71A) MH 175W - 450W

Remote Wiring Configuration Allowed	Yes
Max Ballast-Lamp Distance Remote Wiring	Determined by AWG used
Recommended Fuse Value	10/5/4 A

Approval and Application

Open Circuit Voltage Test (Volts)	270-330 V
Approval Marks	ULR CSA certificate RoHS Compliant
Temperature Marking	D/D/D
UL Recognized	Yes
Hipot Test (1 Minute)	2000 V
Hipot Test (2 Seconds)	2500 V
UL Insulation Class	H(180°C)

UL Temperature Code	1029D
---------------------	-------

Product Data

Order product name	CORE & COIL HID 71A60A1001D
EAN/UPC - Product	781087096659
Order code	913700525509
Numerator - Quantity Per Pack	1
Numerator - Packs per outer box	1
Material Nr. (12NC)	913700525509
Net Weight (Piece)	5.884 kg

Dimensional drawing

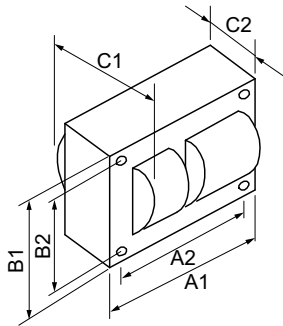

MH BAL 400W M59 120/277/347V KIT

Product	C1	C2	A1	A2	B1	B2
CORE & COIL HID 71A60A1001D	4 in	2.15 in	4.8 in	4.4 in	4.3 in	3.9 in

