

Service Entrance Heads

Threaded For Rigid Conduit or IMC

Type 17

Entrance Caps

Use:

Provides a weather-resistant termination of a Service Entrance Conduit Riser at utility connection point.

Features:

- Weather resistant.
- Phenolic Insulator has predrilled holes to slip over conductors.
- Easy to assemble onto conduit riser.

Material:

Malleable or Ductile Iron
Phenolic Insulator

Finish:

Hot Dip or Mechanically Galvanized

Third Party Certification:



UL Listed: E-11857



CSA Certified: 9795

Applicable Third Party Standards:

UL Standard: 514B
CSA Standard C22.2 No. 18

Trade Size (inches)	Catalog Number	Insulator Hole No. Holes	Insulator Hole Dia. (inches)	Dimensions in Inches		
				A	B	C
1/2	17-50G	4	19/64	3 3/8	2 1/16	2 1/8
3/4	17-75G	2	3/8	3 1/16	2 5/16	2 1/16
		3	13/32			
1	17-100G	2	7/16	3 3/4	2 11/16	2 13/16
		3	1/2			
1 1/4	17-125G	2	27/64	4 7/16	3 3/8	3 3/4
		3	5/8			
1 1/2	17-150G	3	7/8	5	3 3/16	3 3/16
		1	7/16			
2	17-200G	2	3/4	5	5 3/4	6 15/16
		3	1 1/32			
		1	17/32			
2 1/2	17-250G	3	7/8	10 1/16	6 5/8	6 3/16
		1	1			
		3	1 5/16			
3	17-300G	4	1 1/4	12 5/16	8	8 1/16
		2	1 1/8			
3 1/2	17-350G	4	1 3/4	12 5/16	8	8 3/4
		2	1 1/8			
4	17-400G	4	1 3/4	12 1/2	8	8 5/16
		2	1 1/8			
5	17-500G	*	*	12 3/4	13 3/16	10 1/2
6	17-600G	*	*	17 3/4	15 1/8	12 1/2

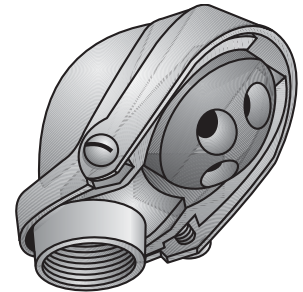

Type 17-50G thru 17-400G

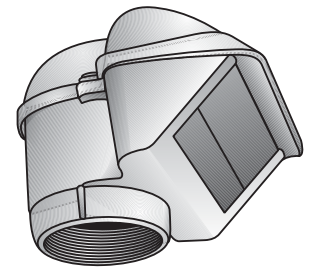

Type 17-500G & 17-600G

*Holes Furnished as Specified. No Charge.

