

55409JV

3/8-16 X 1/2 GD5 CAP SCREW

UPC: 085937025586

Country of Origin:

UNSPSC: 31161501

**Not Available**

Commodity: Cap screws

*Hex Bolts are externally threaded fasteners designed for insertion through holes in assembled parts, and are normally intended to be tightened or released by torquing a nut.*

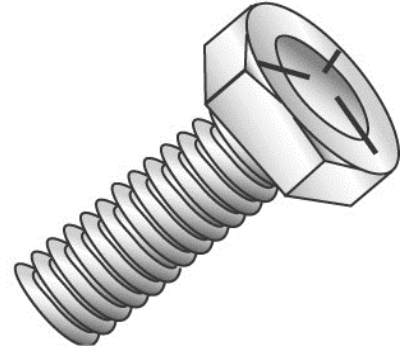

**Product Attributes**

Brand Name	Minerallac Company
Sub Brand	Cully
Type	Hex Cap Bolt
Special Features	Has three hash marks and is made of medium carbon steel—quenched and tempered.
Material	Grade 5 Steel
Size	3/8-16 x 1/2" IN
Length	1/2" IN
Thread Type	Coarse
Thread Size	16 TPI
Head Width	9/16" IN
Head Height	15/64" IN
Head Type	Hex Head
Head Color	Silver
Finish	Zinc Plated

Item Status: Active

Standard Qty: 100

Minerallac Company

Tel: 800-927-3293

Fax: 800-824-8942

www.minerallac.com